

# Cambridge Road

## Eastbourne

**LEX**TONS /  
SALES  
LETTINGS  
AUCTIONS  
COMMERCIAL



## About the property

Welcome to this charming patio studio flat located on Cambridge Road in the picturesque seaside town of Eastbourne. With the seafront at the end of the street, the location is close to the town centre with the train station within easy walking distance.

This modern property boasts a stylish design with plenty of living space, a good size kitchenette with integrated appliances and a shower room.

# Cambridge Road Eastbourne

£750 Per month



1

BEDROOM

0

RECEPTION

1

BATHROOM







SCAN HERE TO VIEW ALL AVAILABLE PROPERTIES

## Ground Floor

Approx. 15.0 sq. metres (161.9 sq. feet)

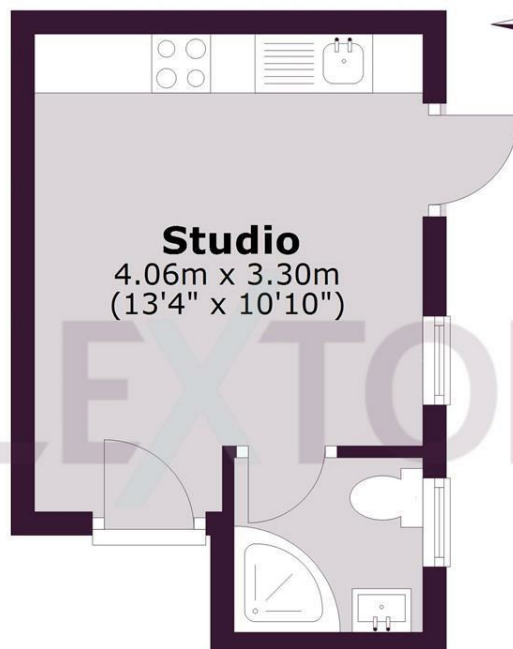

### Studio

4.06m x 3.30m  
(13'4" x 10'10")

Total area: approx. 15.0 sq. metres (161.9 sq. feet)

Whilst every care has been taken to ensure accuracy, dimensions are approximate and for illustrative purposes only.

Created for exclusive use for Lextons. All rights reserved.

Plan produced using PlanUp.

Energy Efficiency Rating		
	Current	Potential
Very energy efficient - lower running costs		
(92 plus) A		
(81-91) B		
(69-80) C	76	77
(55-68) D		
(39-54) E		
(21-38) F		
(1-20) G		
Not energy efficient - higher running costs		
England & Wales		EU Directive 2002/91/EC